

Wildlife and Countryside Act 1981- Modification of Definitive Map
of Public Rights of Way
Map Annexed to FORM 1 [Application]. Claimed Right of Way from
Bridleway 41 in Kea CP to Bridleway 30 in Kenwyn CP

Scale 1:2,044

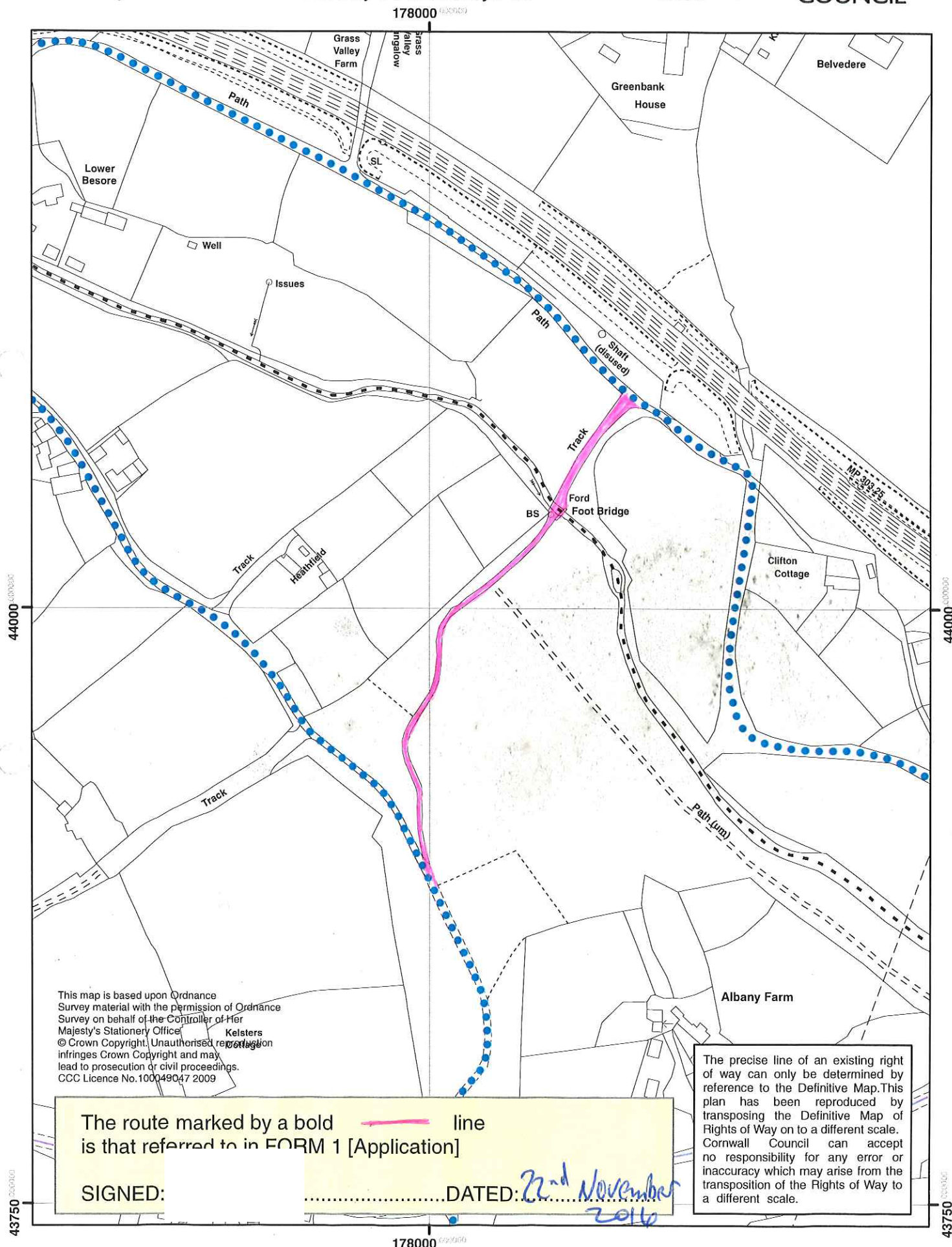

This map is based upon Ordnance
Survey material with the permission of Ordnance
Survey on behalf of the Controller of Her
Majesty's Stationery Office.
© Crown Copyright. Unauthorised reproduction
infringes Crown Copyright and may
lead to prosecution or civil proceedings.
CCC Licence No. 100049047 2009

The route marked by a bold line
is that referred to in FORM 1 [Application]

SIGNED:

DATED:

22nd November
2016

The precise line of an existing right
of way can only be determined by
reference to the Definitive Map. This
plan has been reproduced by
transposing the Definitive Map of
Rights of Way on to a different scale.
Cornwall Council can accept
no responsibility for any error or
inaccuracy which may arise from the
transposition of the Rights of Way to
a different scale.